

Bench Tool

B-TP 060

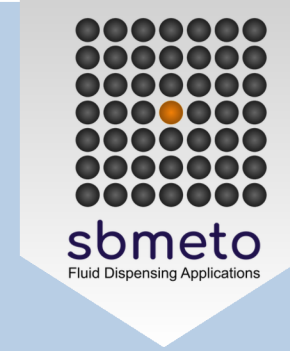

MA

Bench tool for manual automated drops applications



Bench Tool

B-TP 060

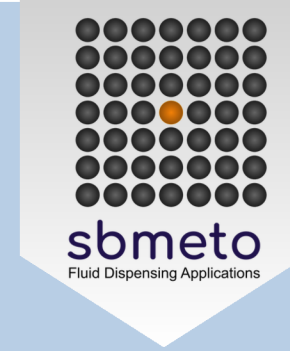

MA

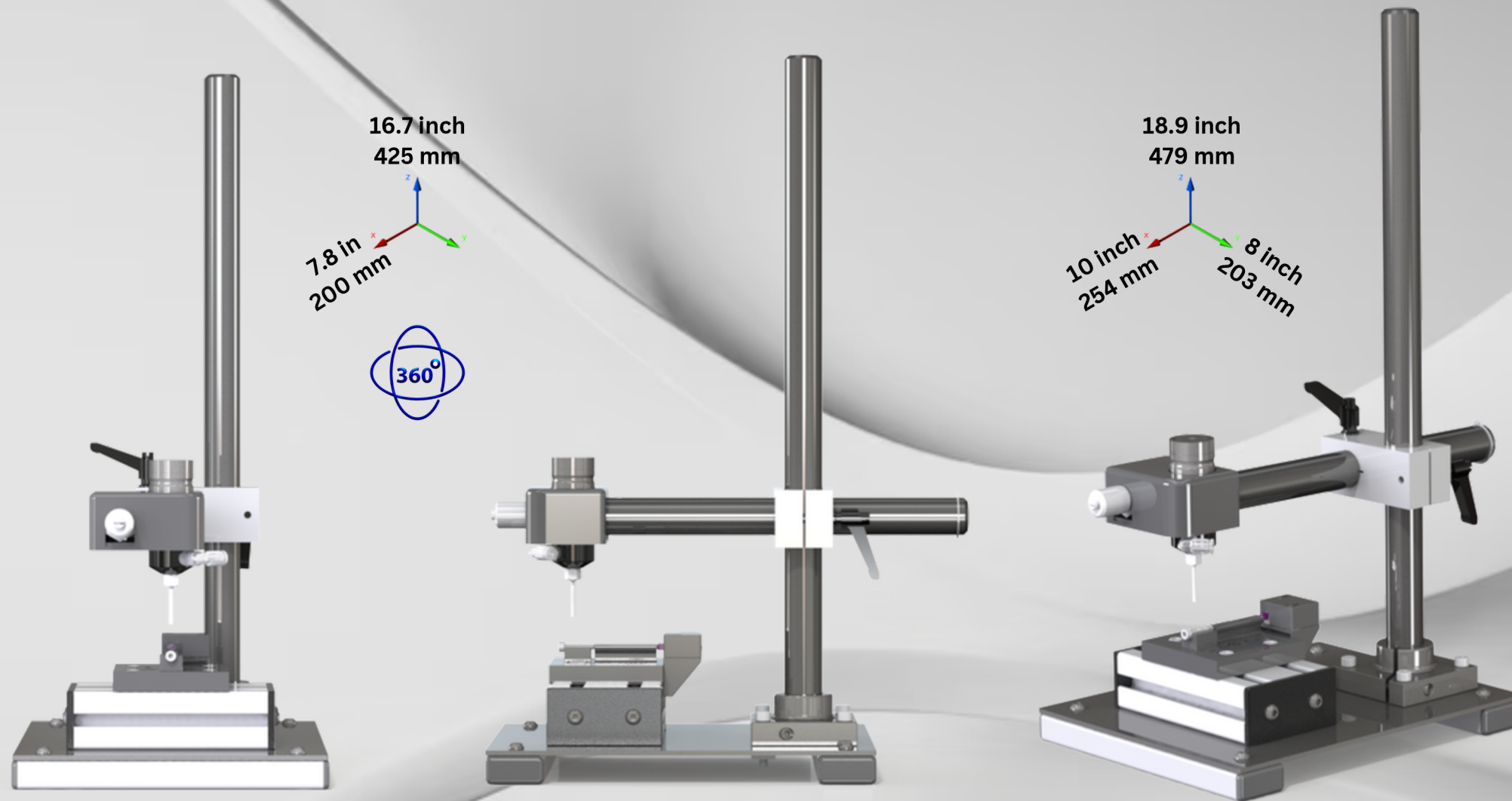

Z-axis Rotating

Two axes linear shafts

The B-TD 060 is an advanced bench tool engineered for precise and efficient thread locker application. Featuring a robust ROIS VM120 diaphragm valve integrated with a Stainless Steel A316L body, the tool combines durability with exceptional performance. Its POM (Acetal) head and PTFE machined patented diaphragm ensure reliable and consistent operation.

Designed with user-friendliness in mind, the B-TD 060 offers a smooth and uninterrupted positioning process. Operators can easily manipulate the two-axis adjustable frame to precisely locate the application point, while the 360-degree rotatable head provides optimal orientation flexibility. The innovative Adjustable Pulse Valve enables precise material dispensing, activated by a convenient pneumatic switch positioned at the end of the screw or part support.

The tool's compact construction makes it ideal for bench-top use. Its POM valve head and plastic internal components are strategically designed to prevent material hardening, ensuring consistent performance.

Bench Tool

B-TP 060



MA

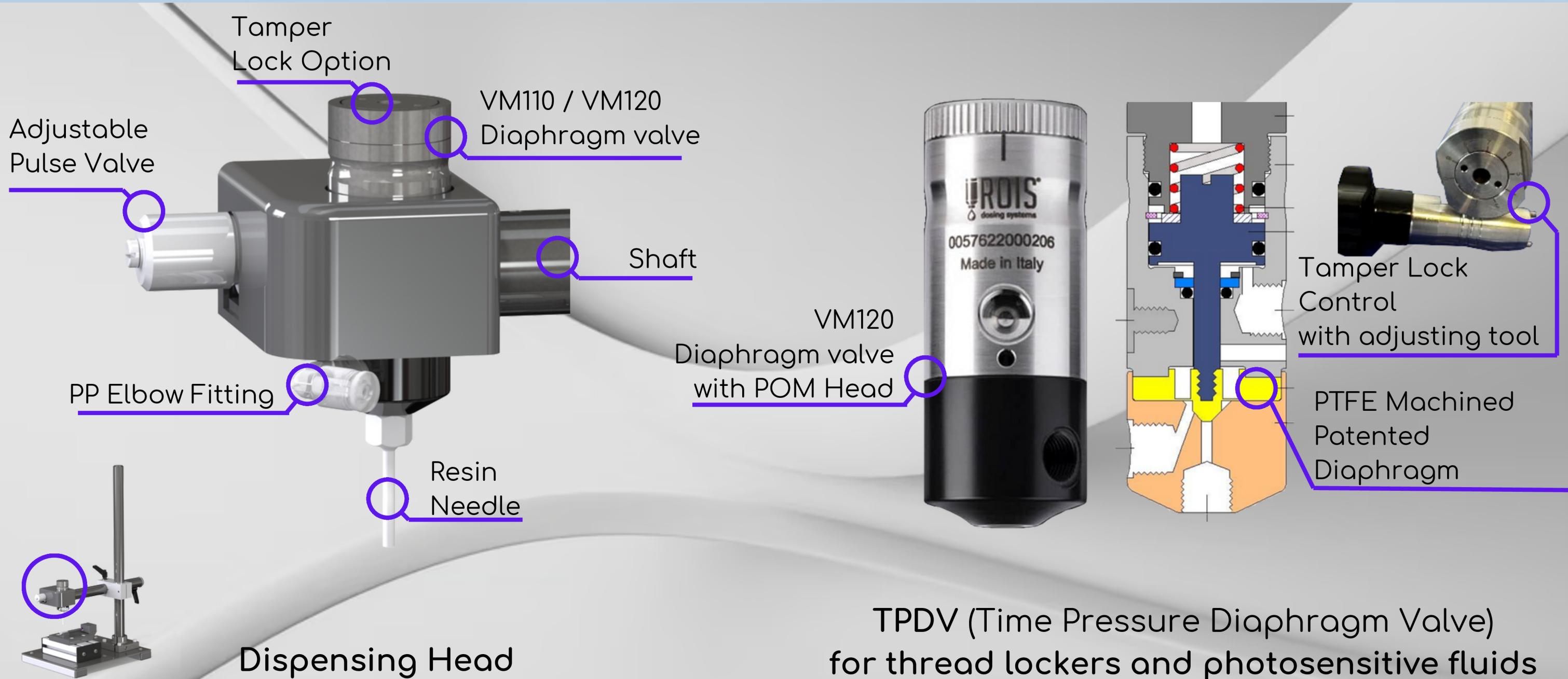

Bench Tool

B-TP 060

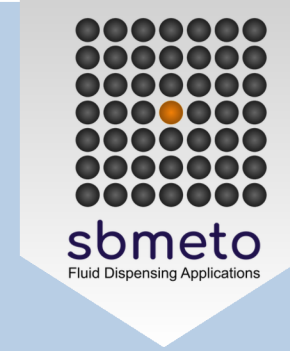

MA

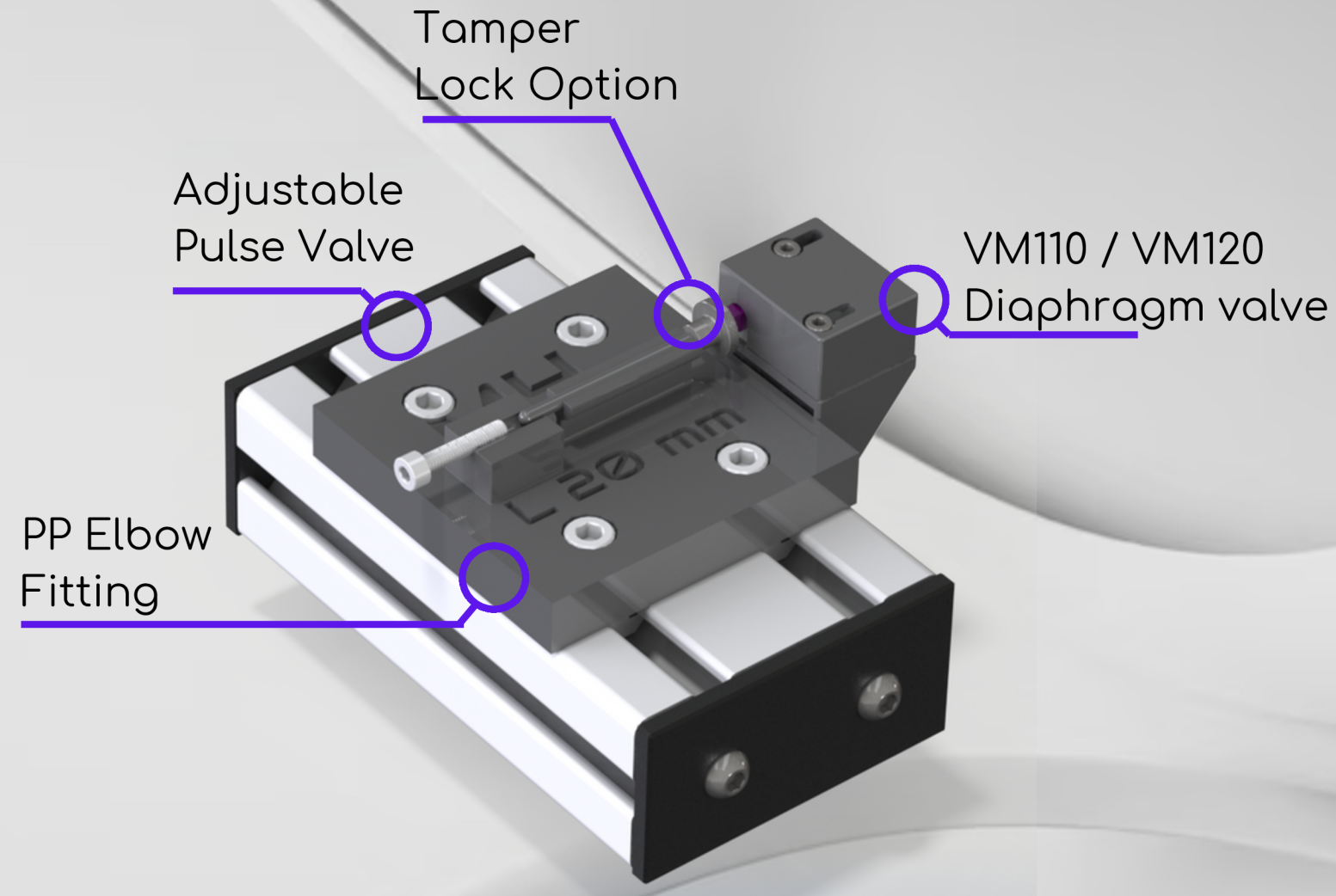

Dispensing Head

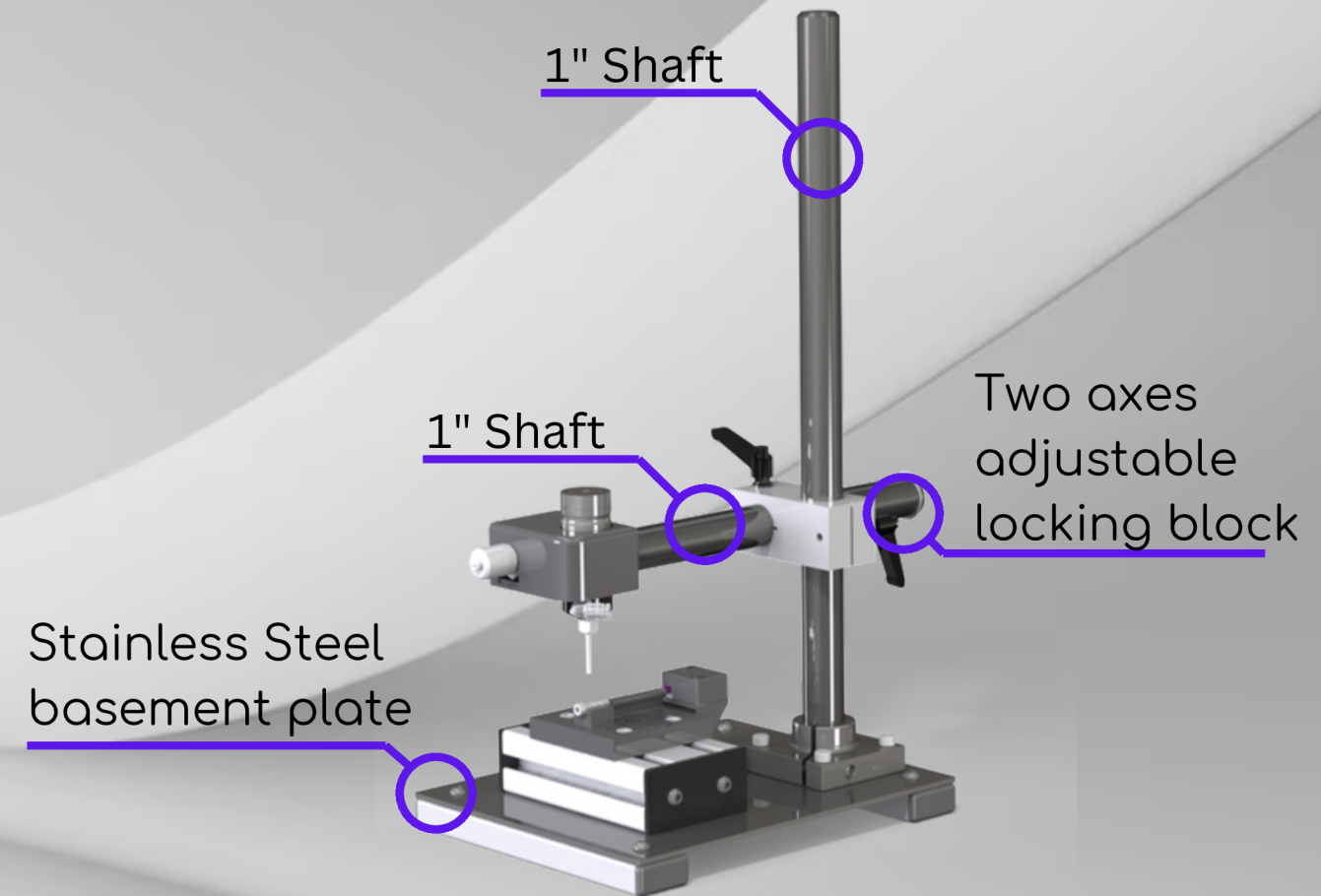

Frame

Bench Tool

B-TP 060

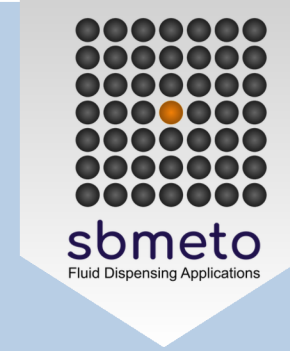

MA

For enhanced versatility, Sunbelt-mte offers optional accessories including PVC pressurized tanks for small volume applications, compact diaphragm pumps, and foot pedal controls. The B-TD 060 represents a reliable, efficient solution for thread locker application across various industrial and manufacturing settings.

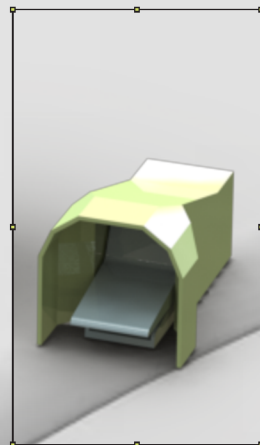
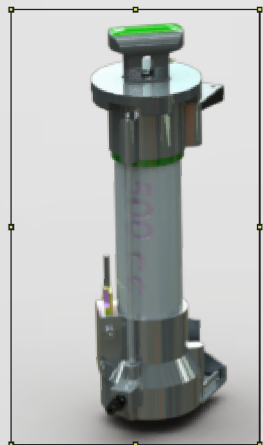

Key Features:

- Integrated ROIS VM120 diaphragm valve
- Stainless Steel A316L body for durability
- POM (Acetal) head and PTFE machined patented diaphragm
- Compact bench-top design for easy workspace integration

Operational Highlights:

- Manual positioning with smooth, uninterrupted process
- Adjustable Pulse Valve for precise material dispensing
- Pneumatic switch activation at the end of the screw/part support
- Two-axis adjustable frame for optimal positioning
- 360-degree rotatable head for versatile orientation

Technical Specifications:

- Valve head constructed of POM (Polyoxymethylene)
- Plastic internal components to prevent material hardening
- Pressurized air inlet supply at 87 psi (6 bar): filtered, regulated

Optional Accessories:

- PVC pressurized tanks for small volume applications
- Compact diaphragm pump for direct suction
- Foot pedal control options
- Sensor to connect with a PLC

Bench
Tool

B-TP 060

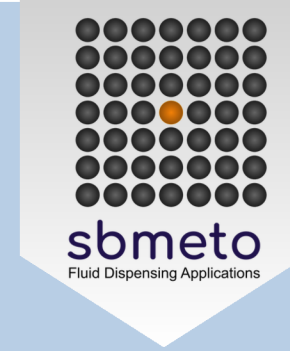

MA

contact us today

info@sbmeto.com

[sunbelt-mte](#)